

**The versatile insulated cavity closer**

# SUPAFIX FLEXICLOSER: FIRST CHOICE FOR SECOND FIX

Dacatie's Supafix Flexicloser, now available to order from any branch of Parkers, is a versatile insulated cavity closer that is easy to use to achieve building regulations where cavity widths are unknown or vary on site.

The product is a particularly useful solution for closing the cavity around window and door frame openings in second fix installations when a frame former is not required.

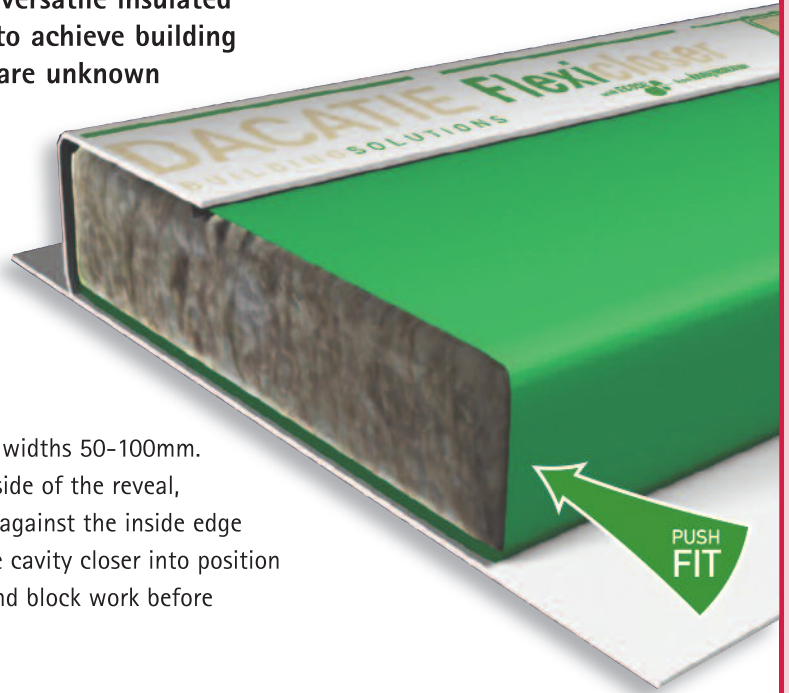

## Installation

SF-Flexicloser can be installed in cavity widths 50-100mm. With the white PVCu flange on the outside of the reveal, position the open end of the insulation against the inside edge of the inner block work (Fig a). Push the cavity closer into position (Fig b). Nail through flange into brick and block work before window or door frame installation.

- Insulation with Ecosse technology  
Green Guide Rating A+
- Zero GWP - Zero ODP
- BRE Compliant
- One size fits all 50 - 100mm
- BRE Compliant (Doc. L)
- One size fits all 50 - 100mm

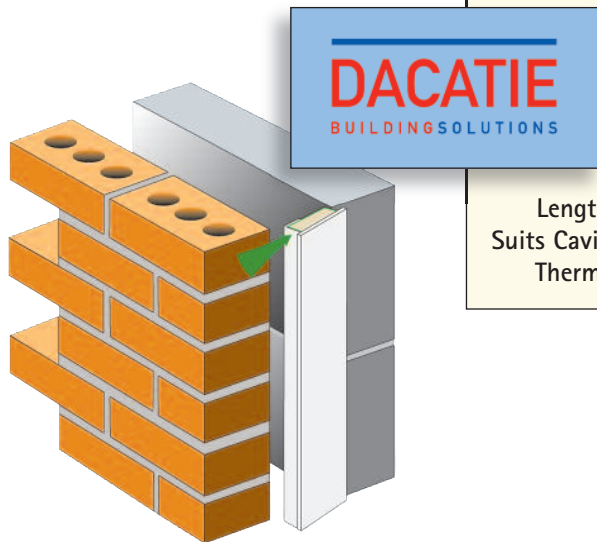

## SPECIFICATIONS

<b>Profile</b>	White non water-absorbing PVCu
<b>Insulation</b>	Mineral wool bonded with Ecosse Technology - a sustainable organic material friendly to the environment. HCFC & HFC Free. Zero Global Warming Potential. Zero Ozone Depletion Potential. K Value 0.035 W/mk. Good moisture resistance
	Knauf Insulation mineral wool (Rocksilk) with Ecosse technology has a resistance to fire which is classified as non-combustible and has a rating of Euroclass A1 to BS EN ISO 13501.
<b>Lengths</b>	2.4 metres
<b>Suits Cavity</b>	50 - 100mm widths
<b>Thermal</b>	Minimal thermal resistance path 0.45m <sup>2</sup> /KW